

# SECTION 1



## AIR CONDITIONERS

(Product Group - 100)

Aircommand	005 - 007
Dometic (including heating)	007 - 009
Truma	007 - 009

## PRIVACY ROOMS

(Product Group - 150)

Fiamma	010 - 011
Coast Awning Wall Kits	012 - 013
Orbit Annexes	014 - 016

## AWNINGS & ACCESSORIES

(Product Group - 200)

Fiamma Awnings	017 - 022
Fiamma Adapter Brackets	022
Awning Accessories	023 - 025, 030 - 033
Fiamma Awning Spare Parts	026 - 029
Floor Matting	034 - 035
Sunscreenes	036 - 038
Carefree Awnings and Accessories	039 - 047

## BUILDING MATERIALS

(Product Group - 250)

Caravan Bed Frames	048
Canopy Lift Mechanisms	049
Pop Top & Camper Parts	050 - 051
Aluminium Extrusion & Mould Infills	051 - 053
Aluminium Cladding	053
Tape Foam	054
Lippert Slide Out Rooms	055 - 056

## FIAMMA CARAVANSTORE AWNINGS

A lightweight bag awning with a manual rollout operation. Specifically made for caravans and minivans, the Caravanstore Awning has an extra wide roller tube which can be rewound without the fabric wrinkling. It takes seconds to roll it out and since the legs are inside the roller tube, they too are quick and easy to position. The legs are hinged and telescopic so they can't fall out and get lost. The design of the Caravanstore Awning has been improved recently and it now comes with a Central Rafter fixing kit to ensure a centre rafter is installed safely (from Caravanstore 255). The lead bar now also features a second track so that a sunscreen or LED lights can be utilised.

### Easy Installation

Slides easily into existing sail track. Once unrolled, simply pull out the legs and position accordingly. When it's time to pack up, the roller tube can be rolled up either way.

### Colours and Materials

Housed in a soft bag with a self-lubricating zipper that won't get stuck. The canopy is available in Royal Grey and is waterproof, rot proof and UV resistant.

Use the table below to choose the right Caravanstore Awning for your RV.



Part Number	Description	Awning Length (A)	Canopy Length (B)	Extension (C)	Shade Surface	Weight
<b>200-20000</b>	Caravanstore 190	196cm	162cm	180cm	2.9m <sup>2</sup>	6.1kg
<b>200-20002</b>	Caravanstore 225	236cm	202cm	225cm	4.5m <sup>2</sup>	7.6kg
<b>200-20004</b>	Caravanstore 255	266cm	232cm	225cm	5.2m <sup>2</sup>	8.4kg
<b>200-20006</b>	Caravanstore 280	288cm	254cm	225cm	5.7m <sup>2</sup>	9.0kg
<b>200-20008</b>	Caravanstore 310	318cm	284cm	225cm	6.4m <sup>2</sup>	10.2kg
<b>200-20010</b>	Caravanstore 360	369cm	334cm	225cm	7.5m <sup>2</sup>	11.3kg
<b>200-20012</b>	Caravanstore 410	419cm	384cm	225cm	8.6m <sup>2</sup>	12.5kg
<b>200-20014</b>	Caravanstore 440	449cm	414cm	225cm	9.3m <sup>2</sup>	13.5kg

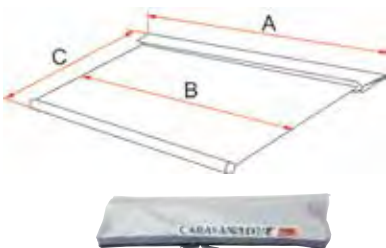

## FIAMMA F35 PRO AWNINGS

Perfect for your minivan, 4x4 or even a station wagon. Housed in a light anodized aluminium case, the Fiamma F35 Pro has a manual mechanism—press the red button on the side of the casing to open and then walk backwards while unrolling the awning. The drop down legs are housed inside the roller tube.

Adapters are available to help with installation onto the roof racks of your vehicle. The fabric is printed on both sides on a UV-resistant and waterproof vinyl. The F35 Pro extends up to 225. Also comes with ropes and hooks for securing to the ground. Available in royal grey colour only.



### 200-20100

#### FIAMMA F35 PRO 180

Length: 180cm  
Extension: 180cm  
Weight: 6.0kg

### 200-20102

#### FIAMMA F35 PRO 220

Length: 220cm  
Extension: 225cm  
Weight: 8.5kg

### 200-20104

#### FIAMMA F35 PRO 250

Length: 250cm  
Extension: 225cm  
Weight: 9.0kg

### 200-20108

#### FIAMMA F35 PRO 300

Length: 300cm  
Extension: 225cm  
Weight: 10.5kg

## FIAMMA F45 S AWNINGS

Fiamma's best selling awning has had a few cosmetic changes, with the result being a more compact and functional box awning. The lead bar now has two tracks allowing for use of a sunscreen and/ or LED lights. The F45 S range of awnings are simple to use and easy to install on the wall of your RV or horse trailer. When not in use, the F45 S takes up little space while snugly enclosed in its polar white aluminium case. It is sturdy and safe to operate, with an easy-to-hook winch loop. The canopy is available in five colours and is UV resistant, waterproof and washable. The colour is printed on both sides of the canopy.

Use the table below to help decide which F45 S awning is right for you.



Description	Awning Length (A)	Height from Ground (B)	Extension (C)	Shade Surface	Weight
F45 S 190	185cm	169cm	100cm	1.7m <sup>2</sup>	11.5kg
F45 S 260	263cm	247cm	200cm	4.9m <sup>2</sup>	19.5kg
F45 S 300	308cm	292cm	250cm	7.3m <sup>2</sup>	23kg
F45 S 350	348cm	331cm	250cm	8.3m <sup>2</sup>	24kg
F45 S 400	398cm	381cm	250cm	9.5m <sup>2</sup>	27kg

Aluminium Case Dimension:

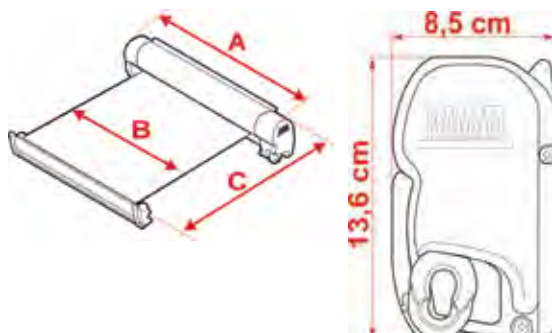

**200-20200**

**FIAMMA F45 S 190**

Royal Grey Awning

**200-20220**

**FIAMMA F45 S 230**

Royal Grey Awning

**200-20240**

**FIAMMA F45 S 260**

Royal Grey Awning

**200-20260**

**FIAMMA F45 S 300**

Royal Grey Awning

**200-20280**

**FIAMMA F45 S 350**

Royal Grey Awning

**200-20300**

**FIAMMA F45 S 400**

Royal Grey Awning

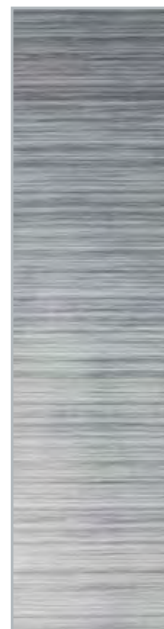

**200-20246**

**FIAMMA F45 S 260**

Deep Black Royal Grey Awning

**200-20264**

**FIAMMA F45 S 300**

Deep Black Royal Grey Awning

**200-20284**

**FIAMMA F45 S 350**

Deep Black Royal Grey Awning



**200-20202**

**FIAMMA F45 S 190**

Royal Blue Awning

**200-20222**

**FIAMMA F45 S 230**

Royal Blue Awning

**200-20242**

**FIAMMA F45 S 260**

Royal Blue Awning

**200-20262**

**FIAMMA F45 S 300**

Royal Blue Awning

**200-20282**

**FIAMMA F45 S 350**

Royal Blue Awning

**200-20302**

**FIAMMA F45 S 400**

Royal Blue Awning

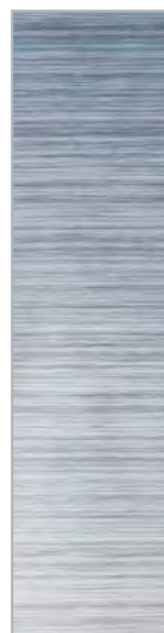



**200-04492****FIAMMA F45 S 260**

Sahara Awning

**200-04517****FIAMMA F45 S 300**

Sahara Awning

**200-04527****FIAMMA F45 S 350**

Sahara Awning

**200-04537****FIAMMA F45 S 400**

Sahara Awning

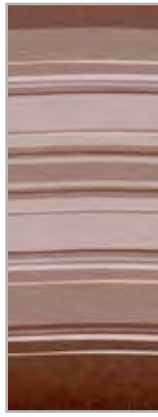
**200-04493****FIAMMA F45 S 260**

Evergreen Awning

**200-04518****FIAMMA F45 S 300**

Evergreen Awning

**200-04528****FIAMMA F45 S 350**

Evergreen Awning

**200-04538****FIAMMA F45 S 400**

Evergreen Awning

**200-04494****FIAMMA F45 S 260**

Bordeaux Awning

**200-04519****FIAMMA F45 S 300**

Bordeaux Awning

**200-04529****FIAMMA F45 S 350**

Bordeaux Awning

**200-04539****FIAMMA F45 S 400**

Bordeaux Awning

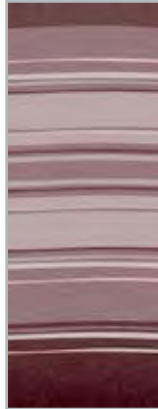
**FIAMMA F45 L AWNINGS**

Perfect for larger RVs the popular F45 TiL has been improved to create the F45 L awnings, featuring an increased box size and extra larger roller tube. The F45L awning provides a large shaded area for your family to enjoy on your next holiday. Suitable for mounting onto the wall of your RV, F45 L awnings open and close by means of a crank handle and have a beautiful polar white aluminium case to compliment any RVs exterior. Silent when opening, closing and even during travel, the F45 L range is sturdy and easy to operate. Best of all, the F45 L case features two guide tracks enabling you to have a sunscreen and a front wall installed at the same time if you so choose! Available in five colours, the vinyls are printed on both sides and are UV-resistant, waterproof and washable to ensure you get quality for your money. Supplied with one Straight Centre Rafter as standard (200-04602).



Description	Awning Length (A)	Height from Ground (B)	Extension (C)	Shade Surface	Weight
F45 L 450	452cm	435cm	250cm	10.9m <sup>2</sup>	35kg
F45 L 500	502cm	485cm	250cm	12.0m <sup>2</sup>	39kg

Aluminium Case Dimension:

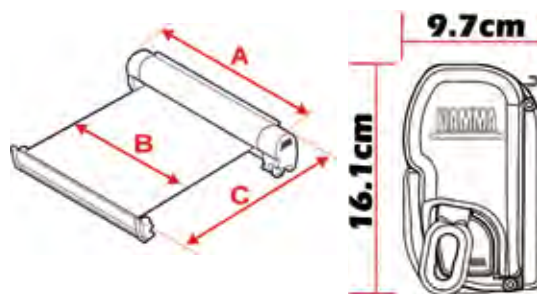
**200-20400****FIAMMA F45 L 450**

Royal Grey Awning

**200-20420****FIAMMA F45 L 500**

Royal Grey Awning



**200-20402**  
**FIAMMA F45 L 450**  
 Royal Blue Awning

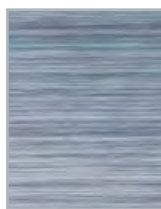

**200-20422**  
**FIAMMA F45 L 500**  
 Royal Blue Awning

**200-04547**  
**FIAMMA F45 L 450**  
 Sahara Awning

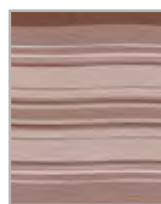

**200-04557**  
**FIAMMA F45 L 500**  
 Sahara Awning

**200-04548**  
**FIAMMA F45 L 450**  
 Evergreen Awning



**200-04558**  
**FIAMMA F45 L 500**  
 Evergreen Awning

**200-04549**  
**FIAMMA F45 L 450**  
 Bordeaux Awning

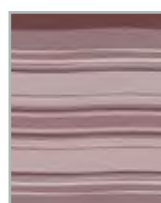

**200-04559**  
**FIAMMA F45 L 500**  
 Bordeaux Awning

## FIAMMA F65 S AWNINGS

The F65S is designed for roof installations on Fiat Ducato and Mercedes Sprinter vehicles. It fits onto the vehicle without any overhang and can be installed without drilling—simply use the optional adaptor brackets suited to the type of vehicle you own. Fiamma recommends installing an F65S 370 on Ducatos with a high roof, built after June 2006. It is easy to operate using a handle to open and close the awning. The casing is made from extruded aluminium and the canopy from UV resistant, waterproof and washable vinyl. (Brackets not included).



Part Number	Description	Awning Length (A)	Canopy Length (B)	Extension (C)	Shade Surface	Weight
<b>200-20530</b>	370 Royal Grey Awning	370cm	358cm	250cm	9.0m <sup>2</sup>	30kg
<b>200-20500</b>	290 Royal Grey Awning	290cm	278cm	200cm	5.6m <sup>2</sup>	25.5kg
<b>200-20510</b>	320 Royal Grey Awning	320cm	308cm	250cm	7.7m <sup>2</sup>	27.5

**200-20532**  
**FIAMMA F65 S 370**  
 Deep Black Royal Grey Awning

Aluminium Case Dimension:

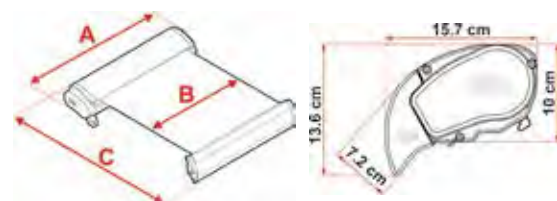

## FIAMMA F65 L AWNINGS

The F65L is a roof awning and is designed with a bigger and stronger case box, perfect for large Motorhomes. It perfectly integrates with the vehicle design without overhanging. The increased and curved dimensions make it stronger and more resistant. (Brackets not included).



Part Number	Description	Awning Length (A)	Canopy Length (B)	Extension (C)	Shade Surface	Weight
<b>200-20602</b>	400 Royal Grey Awning	400cm	380cm	250cm	9.5m <sup>2</sup>	35.5kg
<b>200-20612</b>	450 Royal Grey Awning	450cm	430cm	250cm	10.8m <sup>2</sup>	40.5kg
<b>200-20622</b>	490 Royal Grey Awning	490cm	470cm	250cm	11.8m <sup>2</sup>	44.0kg

### 200-20604

#### FIAMMA F65 L 400

Deep Black Royal Grey Awning

Aluminium Case Dimension:

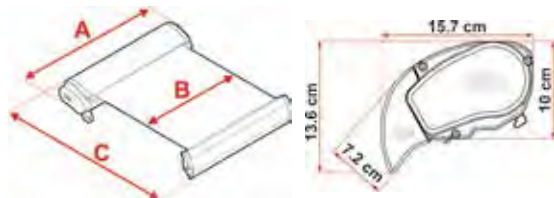

### 200-04600

#### FIAMMA CURVED CENTRE RAFTER PRO

A curved rafter which helps to eliminate water pooling and the canopy from flapping in the wind. It is easy to install, keeps the fabric taut and also provides more under-canopy clearance. Made from two anodized aluminium telescopic bars, the Rafter Pro is best suited to awnings that have an extension of up to 250cm. Its minimum length is 144cm but can extract to 265cm.



### 200-04602

#### FIAMMA STRAIGHT CENTRE RAFTER

Made from anodised aluminium, the Straight Rafter helps to keep the awning taut. It comes with wall clips allowing you to mount it, for storage, inside your vehicle. Best suited to awnings that extend up to 250cm, the Straight Rafter's extension ranges from 142cm - 265cm.





**200-04610****FIAMMA CARAVANSTORE CENTRE RAFTER**

An anodised aluminium rafter with a 30mm diameter. It too has a twist open and close function making installation simple.

**FIAMMA ADAPTOR BRACKETS**

If you like the look of Fiamma's F45 range of awning but your RV does not have a flat-walled surface to mount it on, do not worry! Fiamma have a range of adapter brackets allowing you to fit an F45 awning to your RV, some of which don't require any drilling!

**200-04630****FIAMMA AWNING VW T2/T3 FITTING BRACKETS FOR F45**

Suitable for VW T2 and VW T3 vehicles manufactured after 1980. No drilling required. Kit comprised of x2, 8cm brackets.

**200-04632****FIAMMA AWNING VW T4 FITTING BRACKETS FOR F45**

Suitable for VW T4 and VW T4 with a Lift Roof. Drilling required. Kit comprised of x2, 8cm brackets.

**200-04634****FIAMMA AWNING VAN FITTING BRACKETS FOR F45**

Suitable for vans such as Fiat Ducato (manufactured before 1994), Ford Transit, Mercedes Sprinter 208D KB. Drilling required. Kit comes with x2 types of brackets (x2 of each supplied), one suits Fiat Ducato (manufactured before 1994); the other suits Ford Transit, Mercedes Sprinter 208D KB. Brackets are 8cm in length.

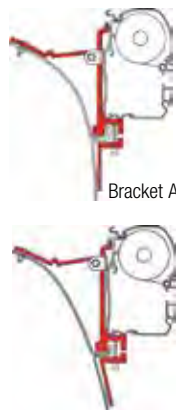
**200-04635****FIAMMA AWNING FIX INSTALL BRACKET "S" (1PCE)**

Suitable for RV's with a flat outer wall. An optional extra bracket for those who wish to strengthen their current mounting. Drilling required. Kit comprises of x1, 12cm "S" bracket.

**200-04653****FIAMMA AWNING MOUNTING BRACKET FOR F45 15 DEGREE**

Suitable for RV's with a slight curve towards the rooftop and for those wanting to mount the awning closer towards the curve of the roof. Drilling required. Kit comprised of x1, 11cm bracket.

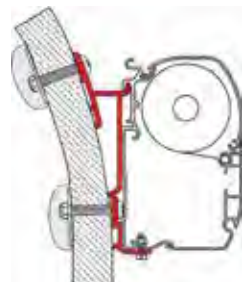
**200-04681****FIAMMA F65S AWNING FIXING KIT**

Suitable for Fiat Ducato, Citroen Jumper and Peugeot Boxers with high roofs built after June 2006. Comprised of x2 20cm brackets and x1 12cm bracket.

**200-04682****FIAMMA F65S AWNING FIXING KIT**

Suitable for VW Crafter and Mercedes Sprinters with high roofs built after June 2006. Comprised of x1 12cm bracket, x1 53cm bracket and x1 60cm bracket.

**200-04714****FIAMMA F35 AND CARAVANSTORE PLASTIC RIVET**

Snap on rivets for the awning leg end on the following models: F35, Caravanstore, F45 and F65. Sold in pairs.



## FIAMMA AWNING RAIN GUARDS

Awning rain guards are a great solution to prevent water from dripping behind the space where your Fiamma awning has been mounted. Made of rubber, the rain guard is installed onto the awning case (no need to remove the awning). Comes in three widths and in 550cm lengths.

### 200-04802

#### FIAMMA AWNING RAIN GUARD L 550CM

Suited to awnings that have been fitted using one of the adapter brackets that resulted in a gap of up to 9cm between the awning case and the RV wall. Can also be used on curved walls.



### 200-04806

#### FIAMMA AWNING RAIN GUARD M 550CM

For awnings, mounted with adapter spaced out from the wall (up to 4cm) or on curved walls.



### 200-04811

#### FIAMMA AWNING RAIN GUARD S 550CM

For awnings installed with the standard AS120 bracket on flat walls. Fits the 1.6cm gap between the flat wall of the RV and the back of the awning case.



### 200-04896

#### FIAMMA WINDING HANDLE TELESCOPIC

This telescopic handle is standard delivered with the F45L awning. Made from light aluminium, it is ideal for high motor homes or caravans, allowing users to easily unwind their awning without stretching. Weighs only 1.32kg. Min length is 154cm but can extend up to 240cm.

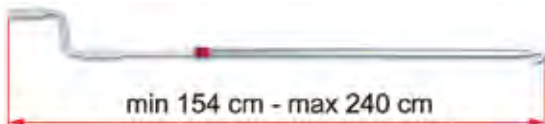

### 200-04898

#### FIAMMA WINDING HANDLE STANDARD 123CM

This 123cm crank handle is standard delivered with F45S awnings up to 400cm. It has a folding handle and is made of ultra light aluminium. It can be cut down if required and weighs only 0.4kg.

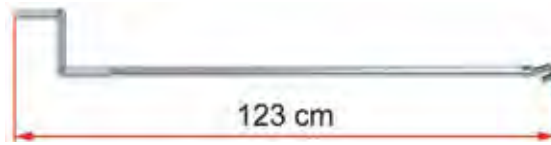

### 200-04900

#### FIAMMA WINDING HANDLE SHORT 51CM

The shortest of Fiamma's crank handles the 51cm version is also made of light aluminium, meaning it only weighs 0.24kg. Ideal for smaller/ lower RVs.



### 200-04901

#### FIAMMA ALU WALL BRACKETS FOR AWNING LEGS

Made of aluminium, these are installed on the outside wall of your RV, allowing you to mount the legs of awning on the side of your RV (instead of vertically dropping to the ground). Suitable for Fiamma F45S, F45L, F65, Caravanstore and F35 awnings. Comes in a set of 2.





**200-04902****FIAMMA LEG WALL BRACKET KIT FOR F45 AWNINGS**

These wall brackets are made of a sturdy, white plastic to complement the colour of your RV. Suitable for F45S and F45L awnings. Comes in a set of 2.

**200-05316****FIAMMA F45 TI SUPPORT LEG REGULATION HAND WHEEL KIT**

This hand wheel secures the extendable legs on Fiamma awnings at the chosen height.

**200-08000****FIAMMA FAST CLIP**

Used to attach the walls of a Fiamma Privacy Room to an awning canopy, the improved Fast Clip system is suitable for use on awnings with a 250cm extension only. Its upper bar is now divided into 4 pieces allowing for precise closing at each section. Each section is now stronger with strengthened joints to minimise central bending. The levers have been made stationary (they can't come out of their position) and bigger. This allows for easier unhooking. By turning the levers, the grip on the awning canopy can be increased/decreased. The plastic end caps have been shaped to limit damage to the side walls when threading them into the track on the Fast Clip System.

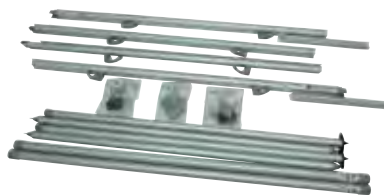
**200-08004****FIAMMA TIEDOWNS (BLACK)**

A Fiamma tie-down that allows for solid anchoring. It fits into the awning rails or the side clip of the privacy room. Comes with two 300cm adjustable bands and the necessary stakes and tension springs.



- > 2x Tie Downs
- > 2x Front Hooks
- > 2x Springs
- > 2x Stakes

**FIAMMA ADAPTORS****200-08007****FIAMMA ADAPTER KIT**

Fiamma Adaptor kit to suit side w pro 4m and under.

**200-08008****ADAPTER KIT FOR CLIP SYSTEM TO FIT FIAMMA F65 AWNINGS****200-08009****ADAPTER KIT FOR CLIP SYSTEM TO FIT FIAMMA F45 TIL AWNINGS**

**250-02037****FIAMMA DELUXE 5B LADDER**

A quality aluminium ladder for sleeping berths in RVs. It has a 15° inclination and handy nylon hooks to hold it in position. The 5B Ladder has five steps.

**Weighs:** 2.6kg

**250-02040****FIAMMA DELUXE 8 EXTERNAL LADDER**

A quality aluminium ladder that is sturdy enough for external use. It has a comfortable 24cm step width with non-skid rungs for added safety. The 8 External Ladder can be folded up during travel and can be installed on the following vehicles: Fiat Ducato, Citroen Jumper, Peugeot Boxer and the Ford Transit (with double rear doors built after 2006). It has eight steps.

**Weighs:** 5.5kg

**250-02039****FIAMMA DELUXE 6 DJ**

A sturdy and lightweight external ladder with non-skid steps. Made from anodised aluminium, it is supplied with fixing bars for quick and easy installation on the rear door. It can also be combined with the Carry Bike 200 DJ (part number 350-02096). The Deluxe 6 DJ is suitable for installation on the following vehicles: Fiat Ducato, Citroen Jumper, Peugeot Boxer and Ford Transit (with double rear doors built after 2006). It has six steps.

**Weighs:** 6.5kg

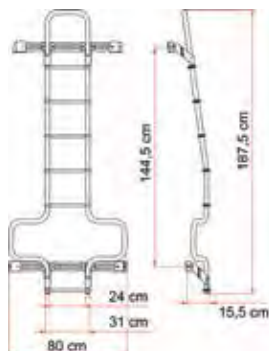

**Please Note:** Part numbers highlighted in red are supplier part numbers and are not readily stocked by Coast to Coast.

**Trade clients:** Please call your local Coast to Coast branch to arrange a special order.

**Retail clients:** Please call your local stockist to arrange a special order.

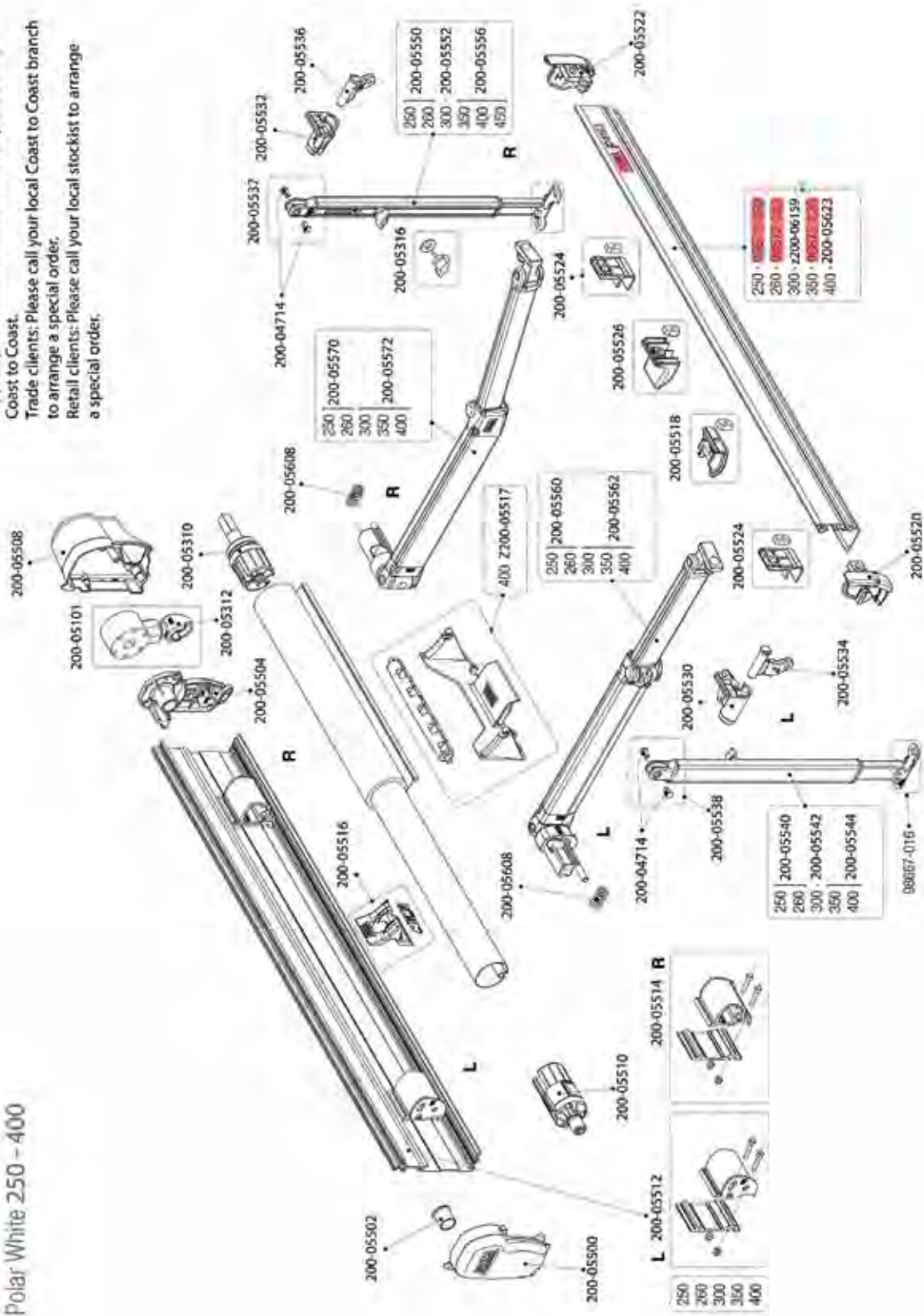



# FIAMMA F45L Polar White 450-500

Please Note: Part numbers highlighted in red are supplier part numbers and are not readily stocked by Coast to Coast.  
Trade clients: Please call your local Coast to Coast branch to arrange a special order.  
Retail clients: Please call your local stockist to arrange a special order.

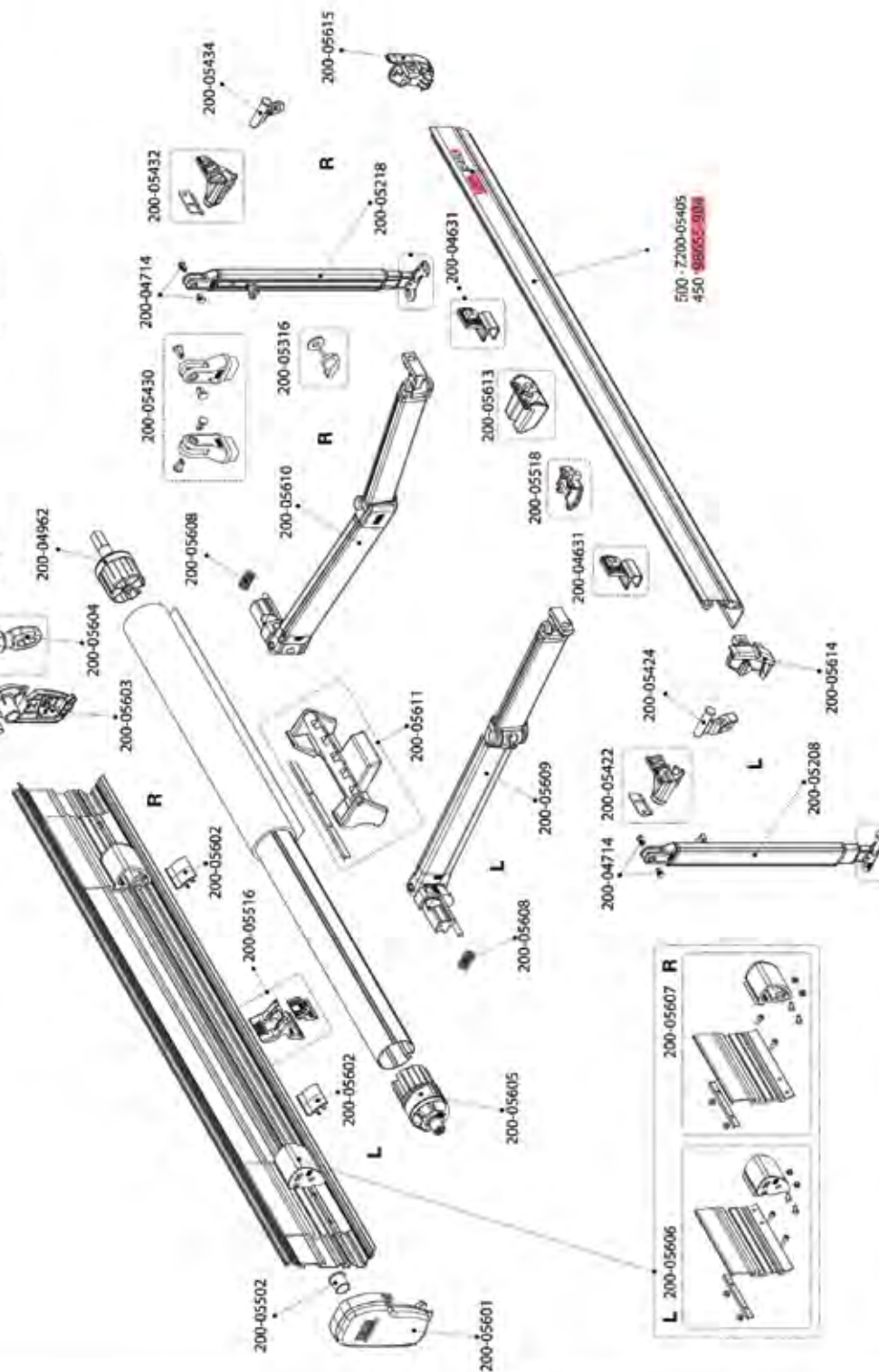

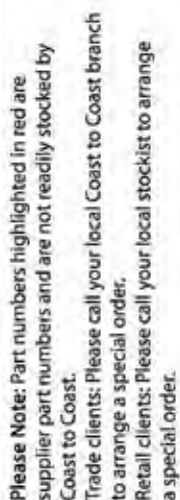

# FIAMMA F65L Polar White 400-490

Please Note: Part numbers highlighted in red are supplier part numbers and are not readily stocked by Coast to Coast.  
Trade clients: Please call your local Coast to Coast branch to arrange a special order.  
Retail clients: Please call your local stockist to arrange a special order.

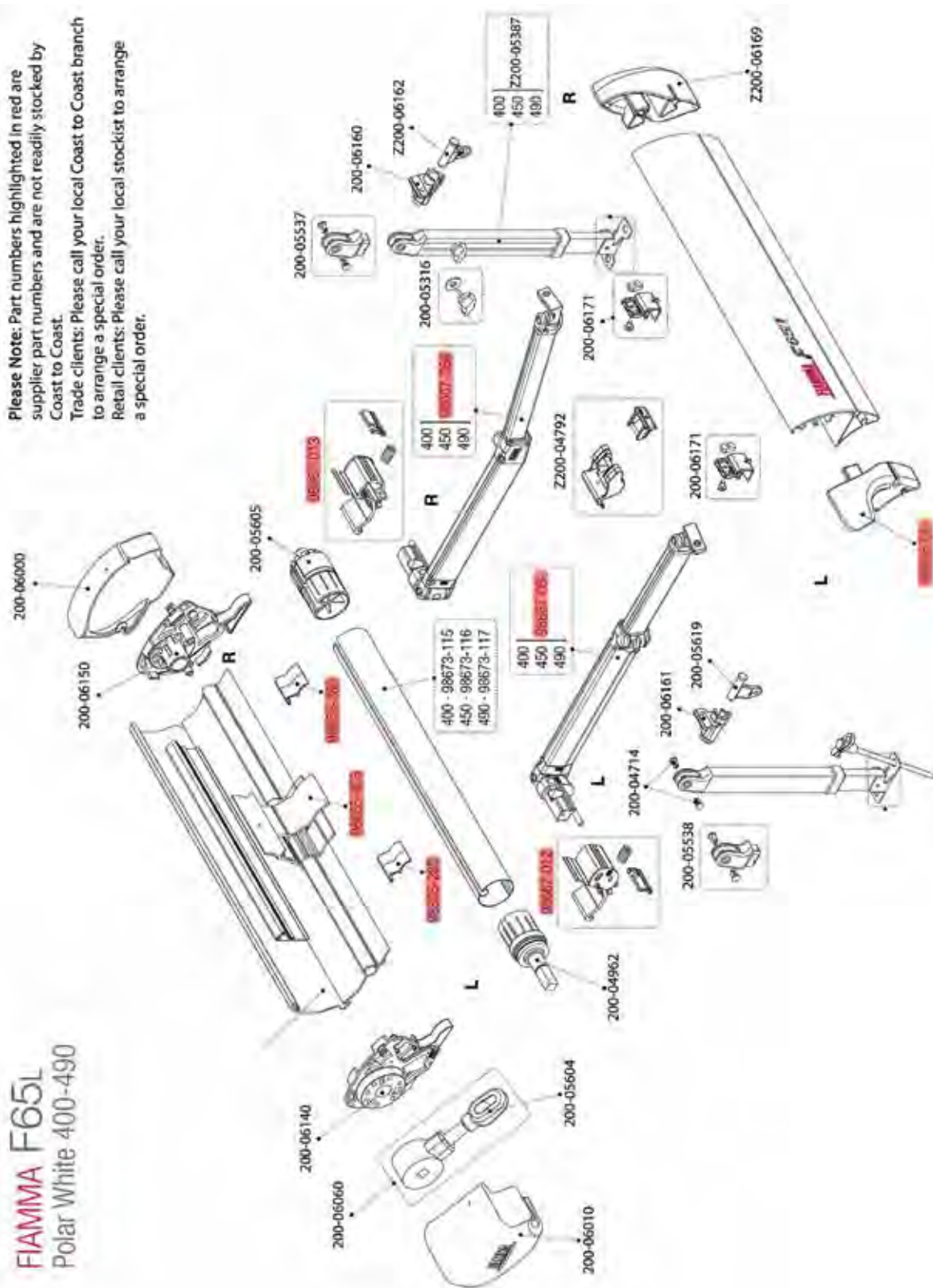



## AUSSIE TRAVELLER ANTI-FLAP KITS

Australian made, this range of Anti-Flap Kits were designed for those RVs with roll out awnings installed. They make adding walls easy, resulting in a wind and waterproof seal between the edge of the awning fabric and the wall. The Anti-Flap Kits come in three sizes depending on the extension of your awning. The Kit itself clamps onto the length of your awning. It has two inbuilt sail tracks allowing you to hang walls quickly as well as a fly net if you have one. Comes with all fittings and instructions.

### 200-08013

#### AUSSIE TRAVELLER SHORT ANTI FLAP KIT ALUMINIUM (WHITE)

Suited to roll out awnings that extend from 210cm up to 220cm.



### 200-08011

#### AUSSIE TRAVELLER MEDIUM ANTI FLAP KIT ALUMINIUM (WHITE)

Suited to roll out awnings that extend from 220cm up to 230cm.



### 200-08012

#### AUSSIE TRAVELLER LONG ANTI FLAP KIT ALUMINIUM (WHITE)

Suited to roll out awnings that extend from 230cm up to 240cm.



### 200-12181

#### AUSSIE TRAVELLER LOCKING KNOB + T-NUT

Replacement knob and T-nut that suits Aussie Traveller anti-flap kits and curved roof rafters.



### 200-12183

#### AUSSIE TRAVELLER AFK BRACKET

Replacement stainless steel mounting brackets that suit Aussie Traveller anti-flap kits and curved roof rafters.



### 200-12186

#### AUSSIE TRAVELLER AFK POLE HOLDER BRACKET

Steel bracket to support a pole along an Aussie Traveller anti-flap kit.



### 200-12216

#### AUSSIE TRAVELLER AFK CAM HANDLES

Replacement Aussie Traveller anti-flap kit cam handle with spring and nut.



## AWNING DE-FLAPPER KITS

Helps to protect awnings from costly rips and tears while reducing wind flapping. The de-flapper securely holds the awning fabric by means of hook and loop velcro straps. Made of durable nylon with UV stabilizers.

**200-08170**

### CARAVAN DE-FLAPPER KIT WITH VELCRO STRAPS

(set of 2)

Clamp Width: 50mm

Strap Length: 130mm



**200-08172**

### POP-TOP DE-FLAPPER KIT WITH VELCRO STRAPS

(set of 2)

Clamp Width: 50mm

Strap Length: 300mm



## MAX DE-FLAPPER KITS

A larger version of the original de-flapper with wider grippers to keep the awning vinyl even more stable.

**200-08180**

### MAX CARAVAN DEFLAPPER KIT

(set of 2)

Clamp Width: 200mm

Strap Length: 140mm



**200-08190**

### MAX POP-TOP DEFLAPPER KIT

(set of 2)

Clamp Width: 200mm

Strap Length: 320mm



**200-08020**

### HAPPY HOOK AWNING TIE DOWN KIT

Designed to pull the roller tube down to tighten the awning vinyl and reduce flapping caused by wind.



**200-08150**

### RV AWNING STABILISER KIT

Secure your awning economically. Extra holding power of spiral stakes works well in all kinds of soil. Tension units keep ropes securely taut. Easy-to-use kit stores compactly and fits all roll out awnings. Great for use on the beach, it attaches to the ends of the roller bar on your awning. Fits all awnings



**200-08160**

### AWNING HOLD DOWN STRAP KIT

Secures your roll out awning by distributing the tension evenly across the canopy. It is a wrinkle resistant strip that fits awnings up to 25'. Kit includes strap, stakes, springs and brackets.



**200-08034****RV TWINTRAK FOR HANGING LIGHTS**

Suitable for awnings up to 18' (5.5m), the Twintrak conveniently turns a single track into a twin track. It allows you to hang sunscreens, lights or other RV accessories all at the same time. Made from strong plastic the Twintrak is supplied in x6, 3' (x6, 91.4cm) pieces.

**200-08144****RV AWNING PARTY LIGHT HOOKS**

Sturdy sewn fabric tabs with grommets that slide into the roller bar channel of your awning. It enables you to hang lights, wind chimes and other lightweight items from the edge of your canopy. Each pack contains x7 tabs.

**200-08142****AWNING HARDWARE STRAPS**

These Velcro straps allow you to replace old or lost awning straps belonging to your rollout awning. They measure 12" (30.5cm) and can also be used to secure other items such as leads or hoses around your RV. Comes in a pack of two.

**200-08080****VLP VINYL REPAIR TUBE**

Great for mending pinholes, rips or tears on awnings and canvas. VLP is a clear, high strength and flexible adhesive that is suitable for use on most types of flexible vinyl surfaces. It has an air dry formula that dries clear, thus blending with coloured fabric. Typical use is on vinyl furniture, awnings, tarps, vinyl sheeting, luggage, rain gear, covers, tent floors and boots. All surfaces to be glued must be free of oil and dust: to achieve this, simply wipe the surface with alcohol and let it dry before applying VLP.

**Specifications**

**Temperature Use Range:** -10°F to 200°F (-23.3°C to 93.3°C)

**Tensile:** (ASTM D-882) 2900Psi

**200-08086****CAMCO RV AWNING REPAIR TAPE - 3" WIDE X 15' LONG**

Camco's RV Awning Repair Tape is a permanent repair for rips and punctures on your RV awning. Use it for RV, boat sails, canvas, tents, rain wear, backpacks, pop up campers and more. It has an aggressive adhesive and resists tearing in any direction. The roll is 7.6cm wide x 4.57m long.

**200-08270****COAST CURVED ROOF RAFTER (WHITE)**

Designed to give your awning canopy a gentle curve enabling rain to run off with ease. Keeping your awning canopy taut it also minimises flapping caused by wind. The Coast Curved Rafter is suitable for awnings that extend up to 8ft (243cm).





**150-00110****SPIGOT MOUNT BRACKET**

Suitable for use with steel extension poles and curved roof rafters.

**AUSSIE TRAVELLER CURVED  
ROOF RAFTERS**

Curved Roof Rafters have a dual purpose - to prevent the awning canopy from sagging, ensuring water run-off, and for keeping the awning fabric taught, reducing wind flap. Awnings that flap can cause your RV to shake or even cause damage to the awning itself. Aussie Traveller has produced two types of telescopic Curved Roof Rafters - suiting most brands of rollout awnings.

Please see the guide below to see how many rafters are recommended per awning:

Awning Size	Recommendation
11' and under	1
12' - 16'	2
17' - 20'	3
21' and over	4

**200-08280****AUSSIE TRAVELLER CURVED ROOF RAFTER MAXI INCLUDING BRACKET**

Curve: 90mm

Extension: 1400 - 2580 (mm)

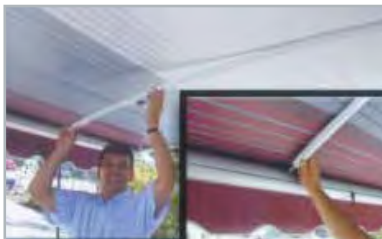
**200-08282****AUSSIE TRAVELLER MINI CURVED ROOF RAFTER INCLUDING BRACKET**

Curve: 60mm

Extension: 1400 - 2580 (mm)

**200-12184****AUSSIE TRAVELLER SPIGOT T/S ROOF RAFTER**

Replacement Spigot that suits Aussie Traveller curved roof rafters.

**200-12185****AUSSIE TRAVELLER END HOOK T/S ROOF RAFTER**

Replacement End Hook that suits Aussie Traveller anti-flap kits and curved roof rafters.

**200-34180****CAREFREE AWNING DOOR ROLLER N' DISC**

## COAST MULTI PURPOSE FLOOR MATTING



Great for any outdoor activity (or even around the home), this floor matting is made from foamed PVC making it a soft, breathable mat that won't kill the grass! It has a non slip feature so items you place on it will stay where you left them. This is a hard wearing, durable mat that has endless uses. Available in three trendy colours.

**200-08300**

**GREEN – 250CM X 300CM – 5KG**

(comes with carry bag)

**200-08302**

**GREEN – 250CM X 400CM – 6KG**

(comes with carry bag)

**200-08304**

**GREEN – 250CM X 500CM – 8KG**

(comes with carry bag)

**200-08306**

**GREEN – 250CM X 600CM – 10KG**

(comes with carry bag)

**200-08308**

**GREEN – 250CM X 30M ROLL**

**200-08310**

**GREY – 250CM X 300CM – 5KG**

(comes with carry bag)

**200-08312**

**GREY – 250CM X 400CM – 6KG**

(comes with carry bag)

**200-08314**

**GREY – 250CM X 500CM – 8KG**

(comes with carry bag)

**200-08316**

**GREY – 250CM X 600CM – 10KG**

(comes with carry bag)

**200-08318**

**GREY – 250CM X 30M ROLL**

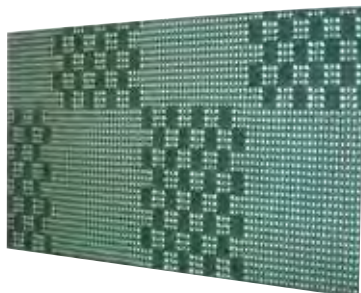

**200-08320****BLUE – 250CM X 300CM – 5KG**

(comes with carry bag)

**200-08322****BLUE – 250CM X 400CM – 6KG**

(comes with carry bag)

**200-08324****BLUE – 250CM X 500CM – 8KG**

(comes with carry bag)

**200-08326****BLUE – 250CM X 600CM – 10KG**

(comes with carry bag)

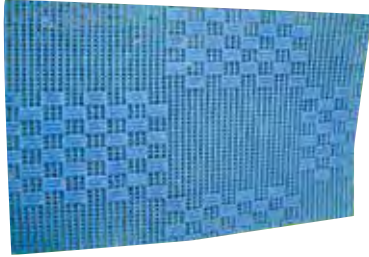
**200-08328****BLUE – 250CM X 30M ROLL**

### ENDUOMATS

Perfect for camping, these Australian made mats help to keep your RV cleaner. Small dirt particles, such as sand, fall through the mesh, leaving larger stones on top for easy removal. Made of a PVC welded fibre, Enduomats are strong, durable and tough but not on the grass underneath! The mesh style fabric allows air to move beneath its surface allowing grass to breath. Non-slip and mildew resistant, the lightweight mat is easy to carry and store. Because nothing sticks to the Enduomat, minimal maintenance is required. To clean, simply shake the mat and then fold as per normal to put back into the bag. It is even UV resistant so it will maintain its colour for years.

**200-08400****ENDUOMAT FOREST GREEN  
(2M X 2.45M)****200-08402****ENDUOMAT FOREST GREEN  
(3M X 2.45M)****200-08404****ENDUOMAT FOREST GREEN  
(4M X 2.45M)****200-08406****ENDUOMAT FOREST GREEN  
(5M X 2.45M)****200-08408****ENDUOMAT FOREST GREEN  
(6M X 2.45M)****200-08410****ENDUOMAT FOREST GREEN  
(7M X 2.45M)****200-08450****ENDUOMAT BLACK (2M X 2.45M)****200-08452****ENDUOMAT BLACK (3M X 2.45M)****200-08454****ENDUOMAT BLACK (4M X 2.45M)****200-08456****ENDUOMAT BLACK (5M X 2.45M)****200-08458****ENDUOMAT BLACK (6M X 2.45M)****200-08460****ENDUOMAT BLACK (7M X 2.45M)**



## COAST FRONT SUNSCREENS



Coast's range of sunscreens has been redesigned resulting in a stronger and more functional sunscreen. The front and side sunscreens now feature an improved spline that won't kink over time. There are also newly added reinforcing triangles (with D-rings) that enable the sunscreen to be secured to awning legs. They are still quick and easy to fit. Once you have taken it out of the packaging, shake it out like a blanket and grab the end without the eyelets. Simply thread it through the track on your awning lead bar.

**Key Features**

- > Improved spline
- > Added reinforced triangles with D-rings
- > Hemmed edging all around prevent to prevent fraying
- > Comes with guy ropes and heavy duty 8mm steel pegs (for securing to the ground)
- > Offers extra privacy
- > Now with a huge 3yr warranty

**ARPAN5A Test Results**

- > Cover Factor: 91.0 +/- 2.5
- > UVR Block: 90.4% +/- 2.5%
- > Shade Factor: 86.6 +/- 2.9
- > Calculated Protection Factor: 11\*

*\* The Calculated Protection Factor is for the material only and does not account for the effect of indirect UVR when situated at a distance from the persons being protected.*

**FRONT SUNSCREENS  
FOR ROLLOUT AWNINGS**

**200-09002**  
**SUITS 10' ROLLOUT AWNING**  
**(W2805MM X H1800MM)**

**200-09012**  
**SUITS 11' ROLLOUT AWNING**  
**(W3110MM X H1800MM)**

**200-09022**  
**SUITS 12' ROLLOUT AWNING**  
**(W3415MM X H1800MM)**

**200-09032**  
**SUITS 13' ROLLOUT AWNING**  
**(W3720MM X H1800MM)**

**200-09042**  
**SUITS 14' ROLLOUT AWNING**  
**(W4025MM X H1800MM)**

**200-09052**  
**SUITS 15' ROLLOUT AWNING**  
**(W4330MM X H1800MM)**

**200-09062**  
**SUITS 16' ROLLOUT AWNING**  
**(W4635MM X H1800MM)**

**200-09072****SUITS 17' ROLLOUT AWNING  
(W4940MM X H1800MM)****200-09082****SUITS 18' ROLLOUT AWNING  
(W5245MM X H1800MM)***\* Rollout awning sunscreens have a 6mm spline***FRONT SUNSCREENS  
FOR BOX AWNINGS****200-09102****SUITS FIAMMA AND CAREFREE 3M BOX  
AWNING (W2850MM X H1800MM)****200-09112****SUITS FIAMMA AND CAREFREE 3.5M  
BOX AWNING (W3350MM X H1800MM)****200-09122****SUITS FIAMMA AND CAREFREE 4M BOX  
AWNING (W3850MM X H1800MM)***\* Box awning sunscreens have a 3mm spline***200-09192****REPLACEMENT BAG FOR 10" - 12"  
SUNSCREENS****200-09194****REPLACEMENT BAG FOR 13" - 16"  
SUNSCREENS****200-09196****REPLACEMENT BAG FOR 17" - 18"  
SUNSCREENS****COAST SIDE SUNSCREENS**

Available to suit Pop Tops and Caravans, the Coast Side Sunscreens are made from the same quality material as the Front Sunscreens. In the case of a Pop Top, the side sunscreen attaches to your awning arm (when extended) by means of velcro straps. If you have a Caravan, you have two installation options; 1) use the Velcro straps to attach it to your awning arm or, 2) if you already have an antiflap device installed with sail track, simply thread the side sunscreen spline through the track. Comes with guy ropes and pegs to secure to the ground. Comes with a huge 3yr warranty!

**200-09202****SIDE SUNSCREEN FOR POP-TOP  
(W2100 X H1800MM)****200-09212****SIDE SUNSCREEN FOR CARAVANS***\* Can also fit into the Fiamma Fast Clip System***200-09198****REPLACEMENT BAG FOR SIDE  
SUNSCREENS**

## CAMPER OFFSIDE PRIVACY SUNSCREENS

Coast to Coast now has a NEW range of camper privacy sunscreens. These are perfect for shading the kitchen and fridge area in most campers as well as providing privacy.

- > Used on the offside of the camper for extra shade and privacy
- > No poles required with a height of 2050mm
- > Suitable for use with most popular brands of camper vans
- > Huge 3 year warranty

**200-09300**

**CAMPER OFFSIDE PRIVACY SUNSCREEN  
(W2220 X H2050MM)**

**200-09302**

**CAMPER OFFSIDE PRIVACY SUNSCREEN  
(W2780 X H2050MM)**

**200-09304**

**CAMPER OFFSIDE PRIVACY SUNSCREEN  
(W3060 X H2050MM)**

**200-09306**

**CAMPER OFFSIDE PRIVACY SUNSCREEN  
(W3380 X H2050MM)**



## COAST FRIDGE VENT SUNSCREENS

**200-09350**

**COAST FRIDGE VENT SUNSCREEN**

Designed to shade the fridge area of your RV. The Coast Fridge Sunscreen will lower the ambient temperature around your fridges vents allowing the fridge to perform better on hot sunny days. The Coast Fridge Sunscreen comes with almost everything you need to install the screen yourself, including 1100mm of sailtrack and eight 12mm x 6 gauge stainless steel mounting screws. To give the finishing touches, the installation kit also includes mould insert to cover the mounting screws and specially designed caps for each end of the sailtrack.

### Features

- > DIY Installation Kit (includes sailtrack, mounting screws, mould insert and end caps)
- > Kink free 6mm spline
- > Tough reinforced D-rings
- > Hemmed edges all around to prevent fraying
- > Guy ropes and heavy duty 8mm steel pegs (for securing to the ground)
- > Comes with a huge 3 year warranty.





## CAREFREE ROLL OUT WINDOW AWNINGS

Window awnings offer an alternative to roll out awnings but still provide essential protection from the sun. Carefree have modified their window awnings to incorporate a more streamlined design. The vinyl has also been given an update to an opaque white, complementary to any RV exterior. Two types of Carefree Window Awnings are available, the SL and the SL XL. The SL window awning is suitable for windows less than 36" (91cm) in height. If your window is more than 36" in height, you will require the SL XL window awning.

**200-31012**

**SL 4FT WHITE WINDOW AWNING**

**200-31014**

**SL 5FT WHITE WINDOW AWNING**

**200-31016**

**SL 6FT WHITE WINDOW AWNING**

**200-31512**

**4FT WHITE SL XL WINDOW AWNING**

**200-31514**

**5FT WHITE SL XL WINDOW AWNING**

**200-31516**

**6FT WHITE SL XL WINDOW AWNING**

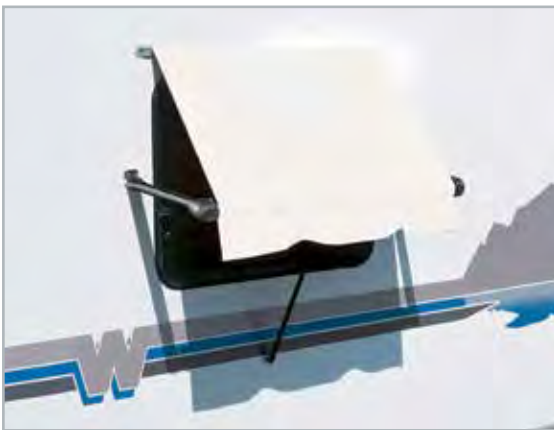

## CAREFREE WINDOW AWNING HARDWARE

**200-31902**

**SL WHITE WINDOW AWNING HARDWARE**

Capable of 18" (46cm) extension

**200-31960**

**SL XL WHITE WINDOW AWNING HARDWARE**

Capable of 30" (76cm) extension



## CAREFREE FIESTA ROLL OUT AWNINGS (NO ARMS)

Carefree's vinyl fabric features a superior construction with the top portion being called the Weatherguard - this protects the fabric from the sun, scrapes and exposure when the awning is rolled up. The Carefree Fiesta has long been a favourite amongst RVers, not only in the USA but here in Australia as well. It is a simple to use manual, spring loaded, rollout awning featuring a vinyl weatherguard as previously mentioned. The Fiesta is available in two finishes, Dune Stripes (this coloured on both sides) and Shale Fades (this is coloured on the top side only). Sizes vary for each colour. The 8' - 14' awnings project up to 7'3" (2.21mt), while the awnings from 15' - 21' project up to 7'9" (2.36mt).



### Fiesta Features

#### Remote and Travel Locks

These work together to ensure the Fiesta does not come undone during travel. They eliminate the need for you to stretch and fumble for the roller lock.



#### Canopy Clamps

Built onto the hardware and self storing. Canopy Clamps help to keep your awning taught and provide extra protection from the elements. Not available on arms supplied to suit poptops.



#### Heavy Duty Brackets

Solid and rugged, the awning hardware and castings are white to suit the trim of any RV.



#### Single Track Slider

Located on the inside of the hardware channels, it eliminates the rafter binding during setup and storage. You get a smooth gliding motion as soon as you slide the rafters up the hardware arms



**CAREFREE ROLL OUT AWNINGS**

200-36000 10FT BLACK & GREY DUNE  
 200-36010 11FT BLACK & GREY DUNE  
 200-36020 12FT BLACK & GREY DUNE  
 200-36030 13FT BLACK & GREY DUNE  
 200-36040 14FT BLACK & GREY DUNE  
 200-36050 15FT BLACK & GREY DUNE  
 200-36060 16FT BLACK & GREY DUNE  
 200-36070 17FT BLACK & GREY DUNE  
 200-36080 18FT BLACK & GREY DUNE

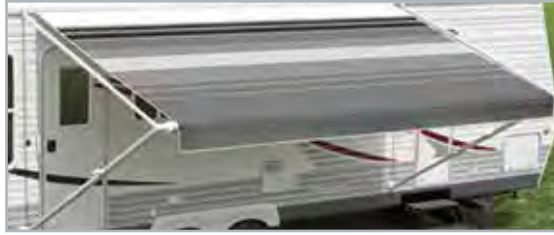

200-36100 10FT OCEAN BLUE DUNE  
 200-36110 11FT OCEAN BLUE DUNE  
 200-36120 12FT OCEAN BLUE DUNE  
 200-36130 13FT OCEAN BLUE DUNE  
 200-36140 14FT OCEAN BLUE DUNE  
 200-36150 15FT OCEAN BLUE DUNE  
 200-36160 16FT OCEAN BLUE DUNE  
 200-36170 17FT OCEAN BLUE DUNE  
 200-36180 18FT OCEAN BLUE DUNE

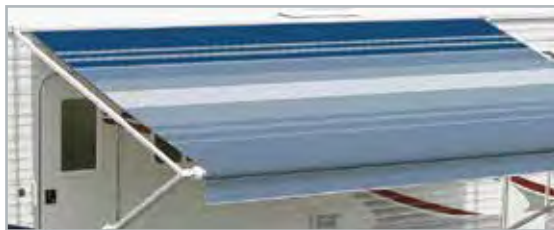

200-36900 10FT BLACK SHALE FADE  
 200-36910 11FT BLACK SHALE FADE  
 200-36920 12FT BLACK SHALE FADE  
 200-36930 13FT BLACK SHALE FADE  
 200-36940 14FT BLACK SHALE FADE  
 200-36950 15FT BLACK SHALE FADE  
 200-36960 16FT BLACK SHALE FADE  
 200-36970 17FT BLACK SHALE FADE  
 200-36980 18FT BLACK SHALE FADE  
 200-36990 19FT BLACK SHALE FADE  
 200-36992 20FT BLACK SHALE FADE  
 200-36994 21FT BLACK SHALE FADE



200-36300 10FT TEAL DUNE  
 200-36310 11FT TEAL DUNE  
 200-36320 12FT TEAL DUNE  
 200-36330 13FT TEAL DUNE  
 200-36340 14FT TEAL DUNE  
 200-36350 15FT TEAL DUNE  
 200-36360 16FT TEAL DUNE  
 200-36370 17FT TEAL DUNE  
 200-36380 18FT TEAL DUNE



200-36400 10FT BLUE SHALE FADE  
 200-36410 11FT BLUE SHALE FADE  
 200-36420 12FT BLUE SHALE FADE  
 200-36430 13FT BLUE SHALE FADE  
 200-36440 14FT BLUE SHALE FADE  
 200-36450 15FT BLUE SHALE FADE  
 200-36460 16FT BLUE SHALE FADE  
 200-36470 17FT BLUE SHALE FADE  
 200-36480 18FT BLUE SHALE FADE



200-36500 10FT BURGUNDY SHALE FADE  
 200-36510 11FT BURGUNDY SHALE FADE  
 200-36520 12FT BURGUNDY SHALE FADE  
 200-36530 13FT BURGUNDY SHALE FADE  
 200-36540 14FT BURGUNDY SHALE FADE  
 200-36550 15FT BURGUNDY SHALE FADE  
 200-36560 16FT BURGUNDY SHALE FADE  
 200-36570 17FT BURGUNDY SHALE FADE  
 200-36580 18FT BURGUNDY SHALE FADE



200-36600 10FT CAMEL SHALE FADE  
 200-36610 11FT CAMEL SHALE FADE  
 200-36620 12FT CAMEL SHALE FADE  
 200-36630 13FT CAMEL SHALE FADE  
 200-36640 14FT CAMEL SHALE FADE  
 200-36650 15FT CAMEL SHALE FADE  
 200-36660 16FT CAMEL SHALE FADE  
 200-36670 17FT CAMEL SHALE FADE  
 200-36680 18FT CAMEL SHALE FADE



200-36700 10FT SILVER SHALE FADE  
 200-36710 11FT SILVER SHALE FADE  
 200-36720 12FT SILVER SHALE FADE  
 200-36730 13FT SILVER SHALE FADE  
 200-36740 14FT SILVER SHALE FADE  
 200-36750 15FT SILVER SHALE FADE  
 200-36760 16FT SILVER SHALE FADE  
 200-36770 17FT SILVER SHALE FADE  
 200-36780 18FT SILVER SHALE FADE  
 200-36790 19FT SILVER SHALE FADE  
 200-36792 20FT SILVER SHALE FADE  
 200-36794 21FT SILVER SHALE FADE



#### CAREFREE LED AWNINGS

Carefree's new LED awning option will make you the envy of the campsite with an adjustable light that is bright enough to read by. This fun, energy-saving dimmable LED's look incredible & are great for parties or just enjoying the evening outside. The 11'-15' awnings project up to 7'3" (2.21m), while the awnings from 16'-20' project up to 7'9" (2.36m).

200-37010 11FT LED SILVER SHALE FADE  
 200-37020 12FT LED SILVER SHALE FADE  
 200-37030 13FT LED SILVER SHALE FADE  
 200-37040 14FT LED SILVER SHALE FADE  
 200-37050 15FT LED SILVER SHALE FADE  
 200-37060 16FT LED SILVER SHALE FADE  
 200-37070 17FT LED SILVER SHALE FADE  
 200-37080 18FT LED SILVER SHALE FADE  
 200-37090 19FT LED SILVER SHALE FADE  
 200-37092 20FT LED SILVER SHALE FADE





## CAREFREE TRIPLE BLACK AWNINGS

It is a simple to use manual, spring loaded, rollout awning featuring a vinyl weatherguard as previously mentioned. Sizes vary - the 11' - 14' awnings project up to 7'3" (2.21m), while the awnings from 15' - 20' project up to 7' 6 3/4" (2.30m).

### Features

- > Black Springs
- > Black Weather Guard (so they roll up black)
- > Black Shale Fade Canopy (when rolled out the canopy has a black balance)

**200-37110 11FT TRIPLE BLACK SHALE FADE**

**200-37120 12FT TRIPLE BLACK SHALE FADE**

**200-37130 13FT TRIPLE BLACK SHALE FADE**

**200-37140 14FT TRIPLE BLACK SHALE FADE**

**200-37150 15FT TRIPLE BLACK SHALE FADE**

**200-37160 16FT TRIPLE BLACK SHALE FADE**

**200-37170 17FT TRIPLE BLACK SHALE FADE**

**200-37180 18FT TRIPLE BLACK SHALE FADE**

**200-37190 19FT TRIPLE BLACK SHALE FADE**

**200-37192 20FT TRIPLE BLACK SHALE FADE**



When replacing the Spring Assembly on your Carefree Fiesta (rollout) awning, take note of the following:

SPRING WIND CHART

Length of Awning	Winds with Awning Closed	Winds with Awning Open
7'11" or less	6	14
8' - 12'	5	13
12' 1" - 18'	7	15
18' 11" and longer	8	16

To wind, rotate the end plug over the top and away from the RV

To unwind, rotate the end plug over the top and toward the RV

## CAREFREE ECLIPSE AWNINGS

The Carefree Eclipse awning is yet another innovative design from these 40 year strong manufacturers. It is a 12V electric awning that extends (and retracts) at the touch of a button (usually mounted near the door of your RV). You can choose to unwind it partially or to its 2.3m full extension. As the worm-gear motor unwinds the canopy, the arms glide up the vertical track (mounted to the outside wall of your RV). The end result is a stable canopy with truss like support. To retract the Eclipse simply hold the button and the motor will roll it up tight against your RV and that's it, eliminating the need to fumble for roller locks:



### Eclipse Features

#### Unmatched Performance

Eclipse has remarkable strength and support for an automatic awning, not to mention it's stylish good looks.



#### Self Levelling

No need to level the canopy before you roll it up and the genius part is that when you do unwind it again, it will unwind to its last setting.



#### Rain-dump Feature

When your Eclipse is on a flat pitch and rain is pooling on the canopy, the gas strut will momentarily retract and dump the water.



**Adjustable Pitch**

There are 6 settings on the awning arm giving you options to maximise shelter from the sun and rain.

**200-36800****14' ECLIPSE 12V SILVER SHALE FADE (NO ARMS, NO SPRINGS)****200-36810****15' ECLIPSE 12V SILVER SHALE FADE (NO ARMS, NO SPRINGS)****200-36820****16' ECLIPSE 12V SILVER SHALE FADE (NO ARMS, NO SPRINGS)****200-36830****17' ECLIPSE 12V SILVER SHALE FADE (NO ARMS, NO SPRINGS)****200-36840****18' ECLIPSE 12V SILVER SHALE FADE (NO ARMS, NO SPRINGS)**

\* All Carefree awnings are sold in two components, the vinyl and the hardware (arms). The hardware required will vary depending on size and type of RV. Please contact a Coast Team member to determine the correct hardware for your RV.

**200-33000****CAREFREE WHITE SHORT HARDWARE (POP TOP)**

Best suited for Pop Tops or smaller caravans with a straight outer wall i.e. walls with a height of 1.6m - 1.7m from the floor line up to the awning railing.

**200-33002****CAREFREE BLACK SHORT HARDWARE (POP TOP)**

Suitable for use on Pop Tops or smaller caravans with a straight outer wall i.e. walls with a height of 1.6m - 1.7m from the floor line, up to the awning railing.

**200-33008****CAREFREE BLACK LONG HARDWARE (UNIVERSAL)**

Suitable for use on larger caravans with a straight outer wall i.e. walls with a height of 1.7m - 2.1m from the floor line, up to the awning railing.

**200-33010****CAREFREE WHITE LONG HARDWARE (UNIVERSAL)**

Best suited for larger caravans with a straight outer wall i.e. walls with a height of 1.7m - 2.1m from the floor line up to the awning railing. Comes with remote lock.

**200-33012****CAREFREE AWNING HARDWARE 12V ECLIPSE**

12V Awning arms to suit the Eclipse awning. Must be fitted to a flat-walled caravan or motor home. It is 10.8cm wide and requires 1.8mt from the awning rail to the floor line.

**200-33020****CAREFREE WHITE CURVED HARDWARE BENT TOP AND BENT LEG**

Suits RV's with a curved outer wall.

**200-33022****CAREFREE WHITE CURVED HARDWARE BENT TOP AND STRAIGHT LEG**

Suits most RV's with a curved roof such as Winnebagos and Renault Trafic.

**200-34150****CAREFREE SPIGOT KIT FOR CAREFREE RAFTERS**

The Spigot pin fits into the end of the Carefree Centre Rafter, which is then inserted into the awning barrel when extended.



**200-33030****CAREFREE RAFTER STANDARD**

The standard rafter has an awning support cradle and is easy to use. The end with the awning support cradle attaches to your RV wall, allowing the rafter to swing out towards the awning roller (once extended). Simply tighten the knob on the roller and use the lever to fit to the roller. You can make the canopy as tight as you desire but take care not to stress your canopy roller. Comes in polar white and suits the Carefree Fiesta range of awnings.

**200-33040****CAREFREE RAFTER WITH GROUND SUPPORT**

Has the same benefits as the standard rafter but with an additional ground support leg. This prevents the awning roller from sagging (towards the ground) once the awning has been rolled out. The ground support and roller work together to keep the awning roller straight. Comes in polar white.

In storage  
on the side  
of your RV



Ground  
Support  
in use

**CAREFREE SUPPORT CRADLE**

Fits all roller awning brands, the awning support has a pivoting head. Once you roll up your awning, the pivoting head receives the roller and supports it, eliminating weight stress and potential bowing in the centre of your awning roller. The awning supports will not damage the awning fabric. Recommended for use on flat walls of RVs and for awning widths of 16ft or greater.

**200-33050****CAREFREE AUTOMATIC AWNING SUPPORT CRADLE WHITE****200-33060****CAREFREE AUTOMATIC AWNING SUPPORT CRADLE BLACK**



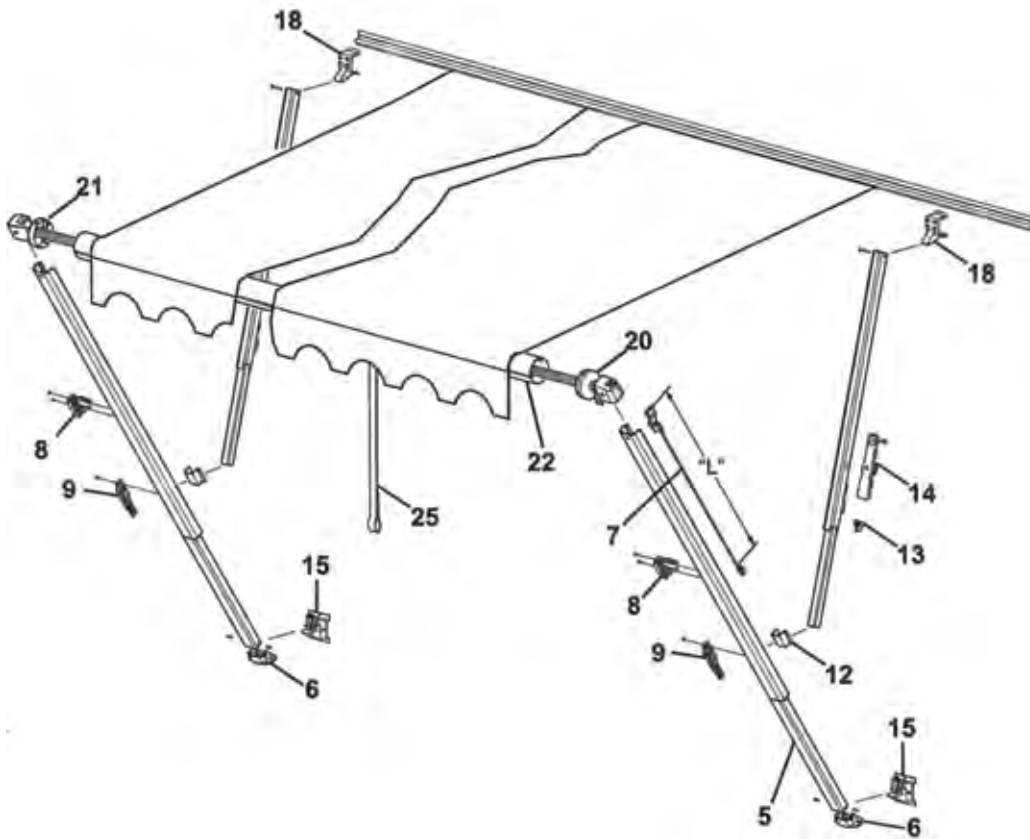

No.	Carefree Part No.	Coast Part No.	Description
6	901020	<b>200-34200</b>	Carefree BLACK car port foot for main inner arm
	901020W	<b>200-34070</b>	Carefree WHITE car port foot for main inner arm
7	901046W	<b>200-34040</b>	Carefree hardware remote lock WHITE - length: 38.5" (97.8cm)
	901046	<b>200-34214</b>	Carefree hardware remote lock BLACK - length: 38.5" (97.8cm)
8	901017	<b>200-34202</b>	Carefree BLACK travel lock
	901017W	<b>200-34050</b>	Carefree WHITE travel lock
9	901015W	<b>200-34060</b>	Carefree WHITE lift handle
	901015	<b>200-34204</b>	Carefree BLACK lift handle
12	R00405	<b>200-34090</b>	Carefree brace slider assembly
13	901022	<b>200-34120</b>	Carefree pair of BLACK locking knob with nut
14	902801W	<b>200-34130</b>	Carefree pair of WHITE canopy clamps
15	901019W	<b>200-34080</b>	Carefree WHITE bottom bracket
	901019	<b>200-34206</b>	Carefree BLACK bottom bracket

18	901018W	<b>200-34140</b>	Carefree WHITE top bracket
	901018	<b>200-34208</b>	Carefree BLACK top bracket
20	R00925WHT	<b>200-34032</b>	Carefree WHITE spring assembly cam end for 8'to18' awning (r/hand)
	R00925BLK	<b>200-34212</b>	Carefree BLACK spring assembly cam end for 8'to18' awning (r/hand)
	R00926WHT	<b>200-34036</b>	Carefree spring assembly cam end 18' to 21' awning (r/hand)
21	R00923WHT	<b>200-34030</b>	Carefree WHITE spring assembly non cam end for 8'to18' awning (l/hand)
	R00923BLK	<b>200-34210</b>	Carefree BLACK spring assembly non cam end for 8'to18' awning (l/hand)
	R00924WHT	<b>200-34034</b>	Carefree spring assembly non cam end 18'to21' awning (l/hand)
25	R022406-001	<b>200-34160</b>	Pull down strap for Carefree Fiesta awning
	030573	<b>200-34194</b>	Carefree Screw 1/4" 20UNC x 1/4" LG S/Steel
	R030345-007-MP	<b>200-34196</b>	Carefree Semi Tube Rivet
	901035	<b>200-34170</b>	Carefree Pull Down Wand

Note: Awning 7'11" and shorter use only x1 R/Hand Spring i.e. there is no L/Hand Spring

## TIPS FOR CAREFREE AWNINGS: CARE AND MAINTENANCE

### Fabric Care

- > Do not use oil-based cleaners or any granulated/abrasive type cleaners on your Carefree awning.
- > The easiest way to delay the need for a deep clean is to simply hose down the awning fabric once a month with clear water - this prevents dirt from becoming set in into the fabric.
- > When the time comes for a thorough cleaning, you can leave the fabric on the frame. For vinyl fabric, simply use a soft brush and warm water with a natural soap. Allow the fabric to air dry completely before rolling back up.

### Mildew

- > A fungus that looks like dirt.
- > Common in areas where temperature and humidity is high, mildew can become a problem.
- > Rinse fabric with clean water and allow to air dry completely before rolling back up.

### Leaking

- > On vinyl canopies, side hems and poly cords are stitched with a sewing machine.
- > The stitching may allow water to seep through - this is normal and not a warranty defect.
- > In this instance, treat the seams with a seam sealer.

### Arm Care

- > Always keep this clean to allow the arms and braces to operate smoothly.
- > Periodically wash out the arm channels with a hose to keep them clean and eliminate dirt and debris.
- > Once the arms have been cleaned and dried completely, you can spray the joints with a dry silicone lubricant.

## CAREFREE FREEDOM 12V AWNINGS

Streamlined and easy to operate, Carefree have released the Freedom 12V box awning that mounts onto the side of your RV. By utilising the button installed inside your RV, you can open and retract the awning. Whilst opening the awning, the support arms (located in the lead bar) can be unfolded once it is at a comfortable and easy-to-reach height. The Freedom's support arms are adjustable by means of flip lock controls. To retract the awning, simply fold support arms back into the lead bar and press the button; the awning case closes and locks itself, so you are ready to continue your journey. The Freedom 12V awnings are housed in an attractive white aluminium casing and are available in two canopy colours.

Use the table below to determine which Freedom 12V awning is best for you:

Awning Size	Canopy Width	Canopy Extension
Freedom 2.5m	2.4m	2m
Freedom 3m	2.8m	2.4m
Freedom 3.5m	3.3m	2.4m
Freedom 4m	3.8m	2.4m
Freedom 4.5m	4.3m	2.4m

Box Dimensions: 14.5H x 9.1D (cm)

Power Requirements: 12V, 15A



**200-38100**

**FREEDOM 2.5M SILVER SHALE FADE**

**200-38110**

**FREEDOM 3.0M SILVER SHALE FADE**

**200-38120**

**FREEDOM 3.5M SILVER SHALE FADE**

**200-38130**

**FREEDOM 4.0M SILVER SHALE FADE**

**200-38140**

**FREEDOM 4.5M SILVER SHALE FADE**

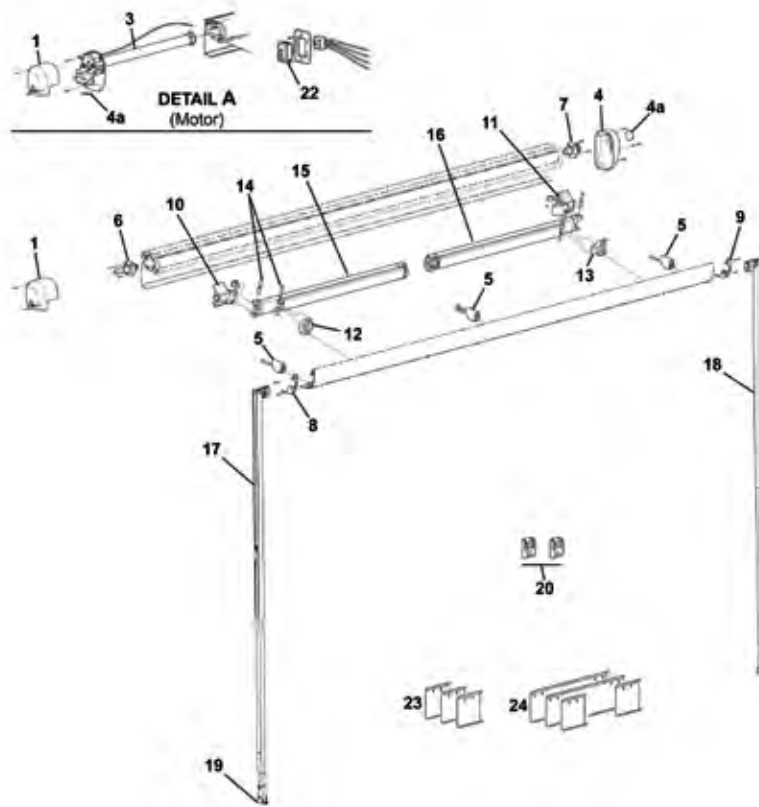

No.	Carefree Part No.	Coast Part No.	Description
6	R001618WHT	<b>200-38502</b>	Freedom L/H End Cap Top White
3	R001637WHT	<b>200-38500</b>	Freedom L/H Motor Assy White
4	R001620WHT	<b>200-38504</b>	Freedom R/H End Cap White
4a	R040792-005	<b>200-38506</b>	Freedom Plug White
5	R001621	<b>200-38508</b>	Freedom Ramp Kit Lead Rail
6	R001622	<b>200-38510</b>	Freedom L/H Roller Tube End Plug
7	R001623	<b>200-38512</b>	Freedom R/H Roller Tube End Plug
8	R001624WHT	<b>200-38514</b>	Freedom L/H End Plate Lead Rail White
9	R001625WHT	<b>200-38516</b>	Freedom R/H End Plate Lead Rail White
10	R001626	<b>200-38518</b>	Freedom L/H Knuckle Assy Case
11	R001627	<b>200-38520</b>	Freedom R/H Knuckle Assy Case
12	R001628	<b>200-38522</b>	Freedom L/H Assy Pivot
13	R001629	<b>200-38524</b>	Freedom R/H Assy Pivot
14	R001630	<b>200-38526</b>	Freedom Hardware Pack Arm Attach - 1 Arm
15	R012530-TB76L	<b>200-38528</b>	Freedom L/H Spring Arm Assy - Used with 2.57m

	R012530-TB94L	<b>200-38532</b>	Freedom L/H Spring Arm Assy - Used with 3.0m & Up
16	R012530-TB76R	<b>200-38530</b>	Freedom R/H Spring Arm Assy - Used with 2.57m
	R012530-TB94R	<b>200-38534</b>	Freedom R/H Spring Arm Assy - Used with 3.0m & Up
17	R001654-001	<b>200-38536</b>	Freedom L/H Vertical Support Leg - Used with 2.44m & 2.57m
	R001654-002	<b>200-38540</b>	Freedom L/H Vertical Support Leg - Used with 3.0m & Up
18	R001654-101	<b>200-38538</b>	Freedom R/H Vertical Support Leg - Used with 2.44m & 2.57m
	R001654-102	<b>200-38542</b>	Freedom R/H Vertical Support Leg - Used with 3.0m & Up
19	R00394	<b>200-38544</b>	Freedom Carport Foot
20	R019283-005	<b>200-38546</b>	Freedom Kit Bottom Bracket White
22	R001605	<b>200-38548</b>	Freedom Switch Kit
23	R019311-001	<b>200-38550</b>	Freedom Hardware Pack 2.43m to 4.0m
24	R019311-003	<b>200-38552</b>	Freedom Hardware Pack 4.50m to 5.0m